

MANUFACTURED BY PARKER - PGI DIVISION

November 2018

Form FVC111 Rev A

**Installation, Operation &
Maintenance Manual
Disassembly and Assembly
Instructions for Models
AL343AS, AL362AS & L424AS**

IMPORTANT: KEEP THIS DOCUMENT WITH THE PRODUCT UNTIL IT REACHES THE END USER.

WARNING!

1. Contact with or inhalation of Liquid Anhydrous Ammonia (NH₃) or of LP Gas, can cause **SERIOUS INJURY OR DEATH**.
2. Before installation or removal of any tank valve, the system must be purged of all product.
3. Personal Protective Equipment (PPE), safety gloves, goggles and clothing should be worn. For proper handling and storage of NH₃, and Liquefied Petroleum Gas, refer to ANSI Standard K61.1. and NFPA Pamphlet 58.
4. An abundant supply of fresh water should be available to provide immediate first aid treatment for exposure to NH₃ and LP Gas.
5. To prevent the accidental opening of any valve, never grasp or carry a valve by its Hand wheel or handle.
6. To ensure a long term and safe operation, the manufacturer recommends that under normal service conditions this product should be inspected at least once every year and be repaired or replaced as required.

WARNING! VALVES NOT FOR AUTO-GAS FILLING APPLICATIONS

Tools Required

Safety Equipment (i.e. gloves, goggles, and clothing), 12" Adjustable Wrench, 1/4" Diameter Drift Pin, small Ball Peen Hammer and 7/16" Open-End or Boxed-End Wrench.

Removal of Valve for Repair or Replacement (Refer to Figure 1 for Item Numbers)

- Step 1: Safety equipment (i.e. gloves, goggles, and clothing) must be worn before proceeding to the next step.
- Step 2: Before removing the valve from the tank, place the valve in the **FULL OPEN POSITION** to ensure all pressure is bled from the system. See WARNING at the top of this page.

Disassembly Procedure for Repair (Refer to Figure 1 for Item Numbers)

1. With the valve secured in a bench-mounted vise, use the 1/4" Drift Pin to remove the Pin ⑳. This will allow the Handle Assembly to be removed from the Stem ①⑥.
2. Remove the Bonnet ⑳ from the Body ①② using the 12" adjustable Wrench. NOTE: The Handle Bearing ⑳, Wiper Ring ⑳, Bonnet Bushing ②④, Stem Seal ②②, Seal Sleeve ②③, Seal Retainer ②①, and Body Bonnet Seal ①⑤ will all remain with the Bonnet when removed.
3. Remove the Stem and Extension Assembly through the top of the Body ①②. NOTE: The Stem Spring ①⑦, and Handle Guide ②⑦ will all remain with the Stem and Extension Assembly when removed. Keep these parts for use during re-assembly.

CAUTION: The complete Stem and Extension Assembly should be inspected before re-assembly is attempted. The following components should be inspected for proper fit and function before the Stem and Extension Assembly is re-used.

1. At Location "A" of FIGURE 1, the Stem Extension ①⑩ must rotate freely inside the Seat Retainer ①③ and have a small amount of end play inside the bore. This interface is mechanically crimped and cannot be disassembled.
2. At Location "B" of FIGURE 1, the Disc Holder ①⑨ should be shouldered snug against the Screw ②.

If inspection of either of these locations yields a problem, the complete Stem and Extension Assembly must be replaced. Refer to the Available Kits Chart on the reverse side for Kit Numbers.

While this information is presented in good faith and believed to be accurate, Individuals using this literature must exercise their independent judgment in evaluating product selection and determining product appropriateness for their particular purpose, system requirements and certifications. The manufacturer reserves the right to change product designs and specifications without notice.

Assembly Procedure (Refer to Figure 1 for Item Numbers)

1. To remove the Disc from the Disc Holder ⑨, remove the Screw ② and the Seat Retainer ③.
2. Re-assemble the valve using a new Disc ①.
3. To replace the Stem Seal ⑳, remove the Handle Bearing ㉕ and Wiper Ring ㉖ from the top of the Bonnet ㉗. Keep these parts for use during re-assembly. Through the top of the Bonnet, press the Bonnet Bushing ㉘ downward using the 1/4" Drift Pin. This will also remove the Stem Seal ⑳, Seal Sleeve ㉙, and Seal Retainer ㉚. Remove the Bonnet/Body Seal ㉛.
4. To install the new Stem Seal and re-assemble the valve, place the repaired Stem and Extension Assembly (or new Assembly Number SQJ-363-1702) through the top of the Body ㉜ until it rests on the Seat ④.
5. Install the Stem Spring ㉞ and Seal Retainer ㉚ over the Stem ㉟ with the small shoulder diameter of the Seal Retainer ㉚ facing upward.
6. Place the Stem Seal ㉟ over the Seal Sleeve ㉙ to create a "Seal Assembly". Lubricate the Seal Assembly with the Dow Corning 112 grease provided in the Seal Kit. With the flange of the Seal Sleeve facing upward, place the Seal Assembly over the Stem ㉟ and carefully press it down until it touches the small shoulder diameter of the Seal Retainer ㉚. Install the Seal Washer ㉜ over the Stem ㉟ with the larger shoulder facing downward.
7. Install the Body/Bonnet Seal ㉛ to the Bonnet ㉗ and lubricate the seal with the Dow Corning 112 grease provided. Carefully place the Bonnet over the Stem and press down until the threads on the Bonnet engage the threads in the top of the Body. Thread the Bonnet down to the top shoulder of the Body and tighten snug with a 12" Adjustable Wrench.
8. Install the Wiper Ring ㉖, with the larger shoulder downward, into the groove on top of the Bonnet and re-install the Handle Bearing ㉕.
9. Install the Handle Pivot Pin ㉟ into the hole on just one side of the Handle ㉟.
Re-install the Handle Assembly (or new Assembly Number S343-1302) over the Stem. Align the Pin with the hole in the Stem and drive it through with a Ball Peen Hammer.

The valve is now assembled and ready for a Mechanical Latch Test and a Pressure Test.

LATCH TEST: Spin the Handle Assembly around the top of the valve three times. Open and close the Handle Assembly three times. To close, strike the top of the Handle and allow the valve to snap shut.

After each closing, be sure the Handle Safety Lock ㉛ latches underneath the Bonnet ㉗ flange. Pull upward on the Handle each time to ensure that the valve cannot be opened unless the Handle Spring ㉞ is depressed. This is an important Safety Feature and will ensure that the valve cannot be accidentally opened when under pressure.

PRESSURE TEST: After the repair is complete and with the valve in the CLOSED position, the Valve Seat ④ and the Stem Seal ㉟ should be "bubble tight" when pressurized at the inlet to 75 PSIG (air) and submerged in water.

Installation of a New or Repaired

1. Apply PTFE tape or sealant on the male threads of the hose or other mating part.
2. Install the Valve and tighten to the desired position, taking care not to over-tighten.

Operation of the Quick Acting Valve

1. To open the Valve, press downward on the flat surface of the Handle ㉟, directly over the Handle Spring ㉞, and lift the Handle to a vertical position. When the Valve is in the full OPEN position, the heel of the Handle will rest squarely on the Handle Bearing ㉕, with the Handle being "pushed over" slightly past the center of the Valve.
2. To close the Valve, tap the Handle in the closing direction with the heel of your hand. The Handle will release in a "Quick Acting" manner to the CLOSED position. The closing spring action of the valve assembly is designed to force the Handle Safety Lock ㉛ to secure itself beneath the Bonnet ㉗ flange, therefore preventing accidental opening of the Valve.

While this information is presented in good faith and believed to be accurate, Individuals using this literature must exercise their independent judgment in evaluating product selection and determining product appropriateness for their particular purpose, system requirements and certifications. The manufacturer reserves the right to change product designs and specifications without notice.

WARNING!

If the Valve is closed slowly by holding the Handle as it is moved toward the CLOSED position, be sure the Handle reaches its STOP position. The Handle Safety Lock must engage beneath the Bonnet flange.

AVAILABLE KITS		
Kit Number	Kit Name & Items Included	Assembly Procedure
SQJ-363-0020	Seal Kit ① ② ③ ⑮ ⑳ ㉑ ㉒ ㉓ ㉔	Steps 1 thru 9
S343-1302	Handle Assy. ⑱ ⑲ ㉘ ㉙ ⑳	Step 9
SQJ-363-1702	Stem & Extension Assy. ① ② ③ ⑨ ⑩ ⑬ ⑯	Steps 4 thru 9

Item	Qty.	Description
1	1	Disc
2	2	Cap Screw
3	1	Seat Retainer
4	1	Seat
5	1	Nozzle/Seat Seal
6	1	Inlet Label
7	1	Speed Drive Swivel
8	1	Nozzle
9	1	Disc Holder
10	1	Stem Extension
11	1	Body/Nozzle Seal
12	1	Body (Angle)
13	1	Seat Retainer
14	1	Spiral Retainer Ring
15	1	Body/Bonnet Seal
16	1	Stem
17	1	Stem Spring
18	1	Handle Safety Lock
19	1	Pin
20	1	Bonnet
21	1	Seal Retainer
22	1	Stem Seal
23	1	Seal Sleeve
24	1	Bonnet Bushing
25	1	Handle Bearing
26	1	Wiper Ring
27		
28	1	Handle Pivot Roll Pin
29	1	Handle
30	1	Handle Spring
31	1	Set Screw

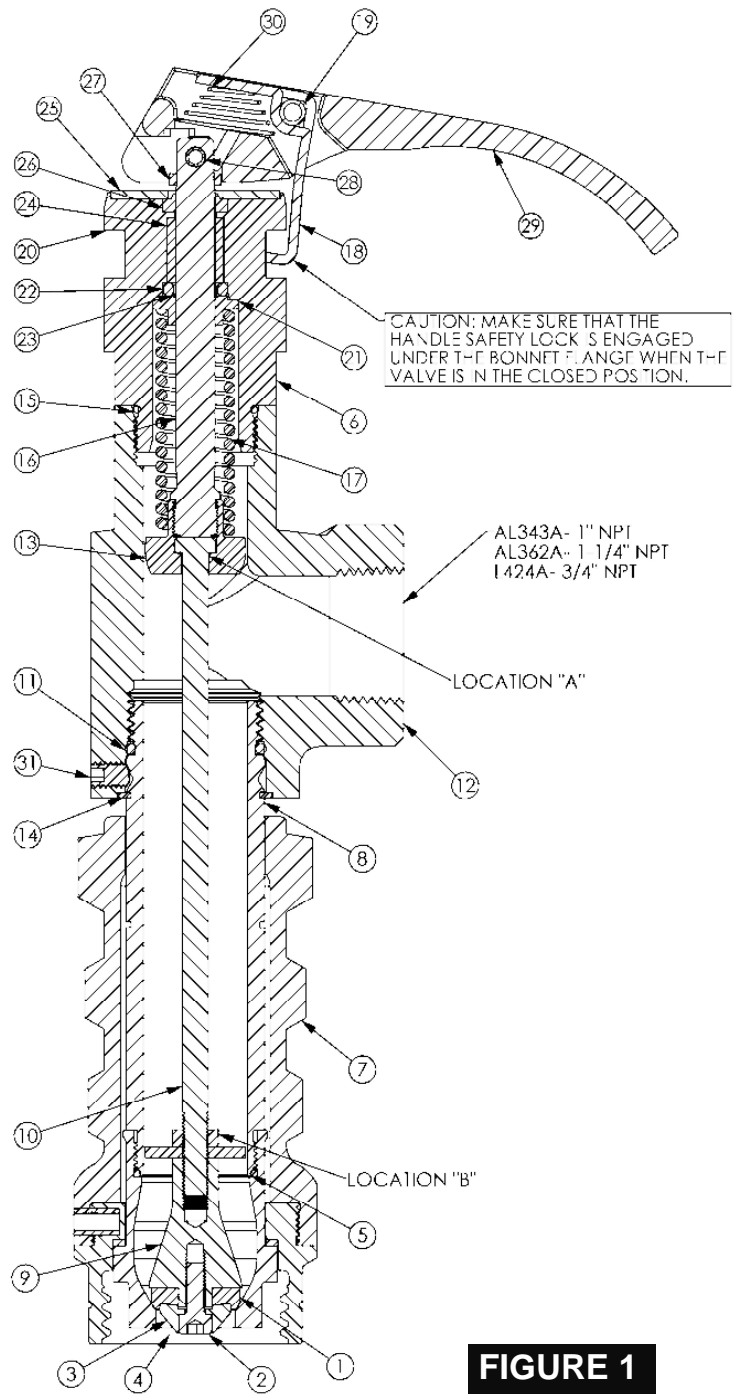

FIGURE 1

While this information is presented in good faith and believed to be accurate, Individuals using this literature must exercise their independent judgment in evaluating product selection and determining product appropriateness for their particular purpose, system requirements and certifications. The manufacturer reserves the right to change product designs and specifications without notice.

USER SAFETY RESPONSIBILITY STATEMENT FOR ALL PARKER PRODUCTS

FAILURE OR IMPROPER SELECTION OR IMPROPER USE OF THE PRODUCTS DESCRIBED HEREIN OR RELATED ITEMS CAN CAUSE DEATH, PERSONAL INJURY AND PROPERTY DAMAGE.

- This document and other information from Parker-Hannifin Corporation, its subsidiaries and authorized distributors provide product or system options for further investigation by users having technical expertise.
- The user, through its own analysis and testing, is solely responsible for making the final selection of the system and components and assuring that all performance, endurance, maintenance, safety and warning requirements of the application are met. The user must analyze all aspects of the application, follow applicable industry standards, and follow the information concerning the product in the current product catalog and in any other materials provided from Parker or its subsidiaries or authorized distributors.

To the extent that Parker or its subsidiaries or authorized distributors provide component or system options based upon data or specifications provided by the user, the user is responsible for determining that such data and specifications are suitable and sufficient for all applications and reasonably foreseeable uses of the components or systems.

While this information is presented in good faith and believed to be accurate, Individuals using this literature must exercise their independent judgment in evaluating product selection and determining product appropriateness for their particular purpose, system requirements and certifications. The manufacturer reserves the right to change product designs and specifications without notice.