

NO.	DESCRIPTION	QTY.
1	HAND WHEEL NUT / DISC NUT	2
2	HAND WHEEL	1
3	STEM	1
4	PACKING NUT	1
5	BONNET	1
6	LOCTITE PACKAGE N/S	1
7	YOKE	1
8	BALL	15
9	DISC HOLDER	1
10	DISC	1
11	DISC WASHER	1
12	INFORMATION DISC	1
13	O-RING	1
14	CHEVRON PACKING	2
15	MALE ADAPTER	1
16	GASKET	1
17	PACKING SPRING	1
18	BODY GASKET	1
19	BODY	1
20	RETAINING SCREW	1
21	1/4" NPT HEX HD. PLUG	1
22	POPPET CHECK	1
23	STEM CHECK	1
24	SPRING	1
25	GUIDE CHECK	1
26	GASKET	1
27	ACME CAP	1
28	SPRING	1
29	UPPER BODY	1
30	GASKET	1
31	STEM	1
32	WASHER	1
33	SEAL	1
34	SEAL CARRIER	1
35	O-RING	1
36	HEX NUT	1
37	WARNING LABEL	1

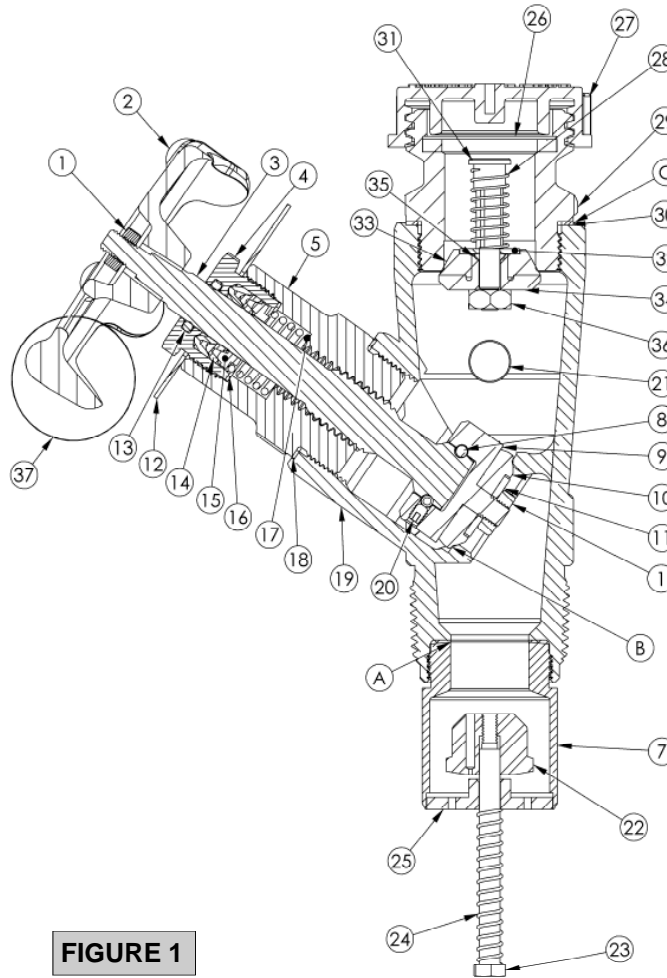

FIGURE 1

AVAILABLE KITS		
NUMBER	NAME & PARTS INCLUDED	ASSEMBLY PROCEDURE
310-0022	SEAL KIT ① ⑩ ⑬ ⑭ ⑮ ⑯	STEPS 1 THRU 11
310-1300	STEM & DISC HOLDER ASSEMBLY ① ③ ⑧ ⑨ ⑩ ⑪ ⑳	STEPS 2 THRU 11
310-1100	BONNET ASSEMBLY ① ③ ④ ⑤ ⑧ ⑨ ⑩ ⑪ ⑬ ⑭ ⑮ ⑯ ⑰ ⑳	STEPS 8 THRU 11
S1597-1145	EXCESS FLOW ASSEMBLY ⑥ ⑦ ⑳ ㉔ ㉕	SEE DIRECTIONS FOR EXCESS FLOW REPLACEMENT
1105-002	SEAL KIT ㉘ ㉙ ㉚ ㉛ ㉜ ㉝ ㉞	SEE DIRECTIONS FOR UPPER BODY ASSEMBLY REPAIR
1105-1125	UPPER ASSEMBLY ㉟ ㊱ ㊲ ㊳ ㊴ ㊵ ㊶ ㊷ ㊸ ㊹ ㊺	SEE DIRECTIONS FOR UPPER BODY ASSEMBLY REPAIR STEPS 4 THRU 6

While this information is presented in good faith and believed to be accurate, Individuals using this literature must exercise their independent judgment in evaluating product selection and determining product appropriateness for their particular purpose, system requirements and certifications. The manufacturer reserves the right to change product designs and specifications without notice.