

# Installation and Operation Manual

## RSD-SVH-AA

January 2016

Form IOM-RSD-SVH-AA - Rev 01

**IMPORTANT: KEEP THIS DOCUMENT WITH THE PRODUCT UNTIL IT REACHES THE END USER.**

1. Contact with or inhalation of Anhydrous Ammonia (NH<sub>3</sub>) can cause **SERIOUS INJURY OR DEATH**.
2. Before installation or removal of any valve, the system must be purged of all product.
3. Personal Protective Equipment (PPE), safety gloves, goggles and clothing should be worn.
4. For proper handling and storage of NH<sub>3</sub>, refer to ANSI Standard K61.1, CGA 2.1 or Local Authority having jurisdiction.
5. An abundant supply of fresh water should be available to provide immediate first aid treatment for exposure to NH<sub>3</sub>.
6. To ensure long term safe operation, the manufacturer recommends that under normal service conditions this product should be inspected at least twice every year and be repaired or replaced as required. Transmitter battery should be checked/tested once daily when in use.

**WARNING: This product should be used with Anhydrous Ammonia (NH<sub>3</sub>) only.**

**DESCRIPTION**

The RSD-SVH-AA is a 3-way solenoid valve module. Together with the RSD-E-BOX or CV-BOX, the system is designed to add shut-down capabilities to a stationary anhydrous ammonia (NH<sub>3</sub>) storage tank equipped with pneumatically actuated valves. In the event of an unintentional product release, the operator may remotely shut-down all pneumatically actuated valves using the RSD-E1 transmitter or the E-STOP palm button. Both of these actions will remove the 12 VDC power to the RSD-SVH-AA 3-way solenoid valve module.

The RSD-SVH-AA should be installed in-line with the air supply line to all pneumatically actuated valves. Applying 12 VDV to the RSD-SVH-AA control cable will activate the internal 3-way solenoid, allowing supply air to pass through to all connected pneumatically actuated valves. When 12 VDC is removed from the control cable, the internal solenoid will close-off the supply air and vent the air from the supply line, allowing the valves to return to the default position.

**SHUT-OFF VALVE ELECTRICAL SPECIFICATIONS**

Operating Voltage: 12 VDC  
 Current Rating: 1 Amp

**ENCLOSURE SPECIFICATIONS**

Size: 7.38" x 4.7" x 3.1" (L x W x D)  
 Weight: 2.5 lbs.  
 Enclosure Material: Diecast Aluminum  
 Enclosure Rating: Weather-tight IP66

**MOUNTING INSTRUCTIONS**

The RSD-SVH-AA enclosure has a weather-tight IP66 Rating and is required to be mounted in the vertical position (wiring and air connection at the bottom). The enclosure includes a mounting flange at the top and bottom with two 3/16" slotted holes on each flange accessible for wall mounting.

**INTERNAL and EXTERNAL VIEWS**



*While this information is presented in good faith and believed to be accurate, Individuals using this literature must exercise their independent judgment in evaluating product selection and determining product appropriateness for their particular purpose, system requirements and certifications. The manufacturer reserves the right to change product designs and specifications without notice.*

## ELECTRICAL WIRING



Disconnect the power prior to maintenance or installation of any electronic or electrical device. Failure to do so could cause injury or death.



Any changes or modifications not expressly approved by the PGI Business Unit - IPD Division of Parker Hannifin Corporation could void the user's authority to operate this device.

**WARNING:** ALL ELECTRICAL CONNECTIONS MUST BE MADE BY A LICENSED ELECTRICIAN OR AUTHORIZED PERSONNEL ONLY.

**NOTE:** SHUT-OFF VALVE WIRING IS NOT POLARITY SENSITIVE.

## FITTING SPECIFICATION

Material: Nickel-Plated Brass Push-To-Connect-Fitting For 1/4" tubing

Tubing: To connect tubing, push air line up to connect

To disconnect tubing, push green ring upward while pulling air line down to disconnect

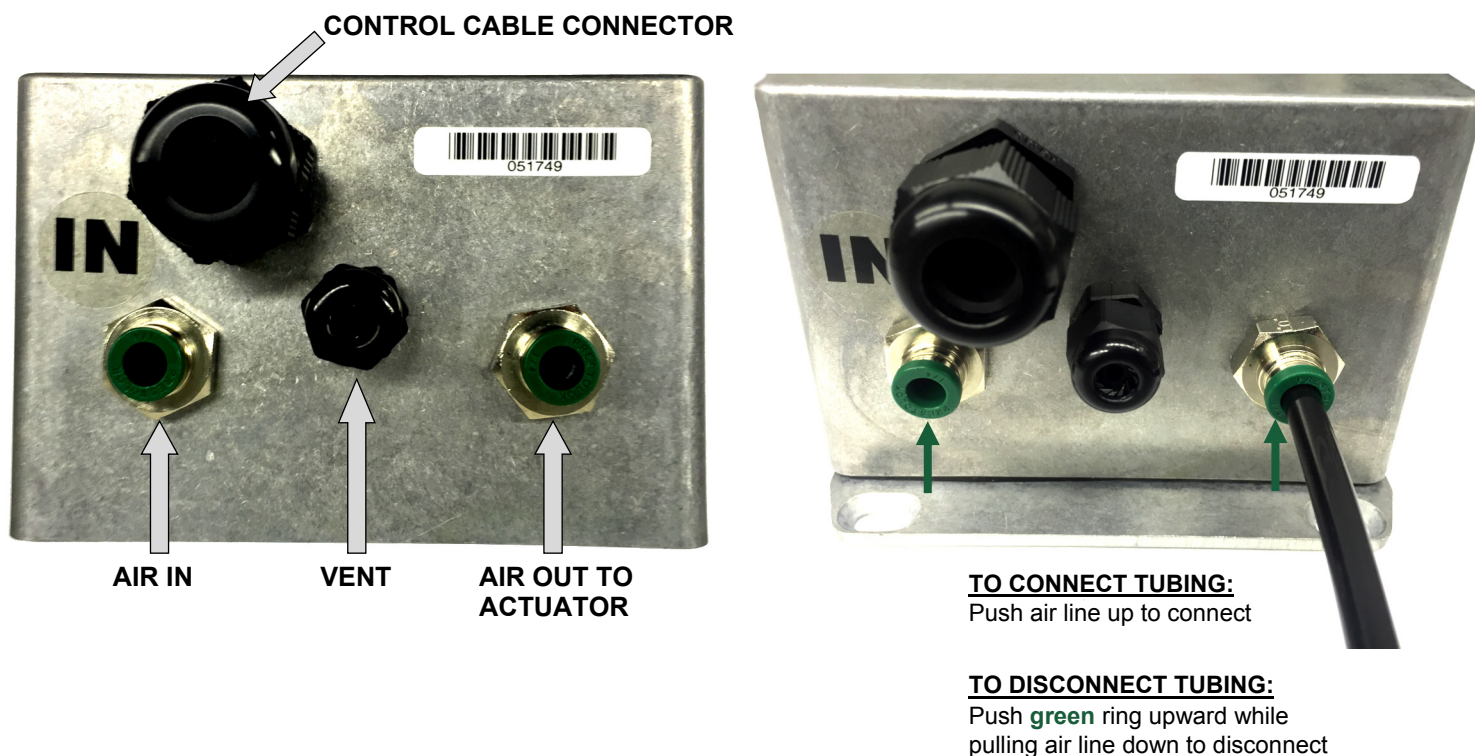

## CONTACT SQUIBB-TAYLOR

If you have any additional questions about anything contained in this manual or desire additional copies, please call Squibb-Taylor at 1-800-345-8105.

While this information is presented in good faith and believed to be accurate, Individuals using this literature must exercise their independent judgment in evaluating product selection and determining product appropriateness for their particular purpose, system requirements and certifications. The manufacturer reserves the right to change product designs and specifications without notice.